

2. Maintenance

2.1 Opening the Device

Detach the device from the clip if you need to replace the battery, or to connect the device to your computer.

Use a paperclip or similar-shaped tool to separate the device from the clip.

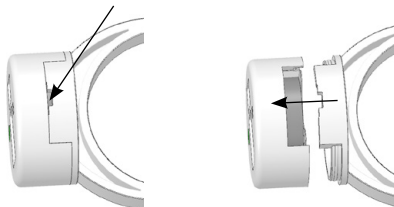

Please note: opening the device—other than to change the battery—or tampering with the internal parts, will void the factory warranty.

2.2 Replacing the Battery

Replace the battery annually, or when the empty battery indicator icon is displayed. When removing the battery or USB power source, the device will still remember its last display, and once reconnected to a power source, it will recall the status last shown before the power source was removed.



The low battery indicator icon displays when it is time to replace the battery.

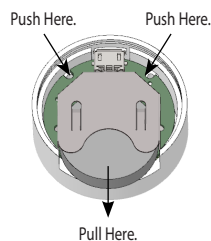

Push the battery out of the retainer with the use of a pencil-shaped object.

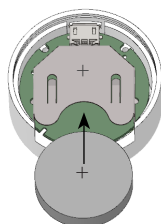

Slide the new battery into the retainer with the positive (+) side of the battery facing up.

2.3 Cleaning

Always remove the battery and/or the USB power source before cleaning the device. Not removing the battery before cleaning the device can cause a short circuit, might destroy electronic components, and also voids the manufacturer's warranty.

Wipe the plastic casing with a slightly damp microfiber or other soft, lint-free cloth. Use a dry cloth or paint brush to whisk away dust from the casing.

To remove dust on the electronics, use compressed air. Never use water to clean the electronics as this may damage the electronic parts of the device and cause a short circuit.

Disposal



The device or battery should not be placed in household waste bins. Please check local regulations for information about the disposal of electronic products in your area.

Warranty Information

Scientific Glass Technology Singapore Pte Ltd warrants that the Electronic Maintenance Indicator will be free from defects of workmanship and materials for two (2) years from the date of purchase by end user. Return defective device directly to Scientific Glass Technology Singapore Pte Ltd, and we will repair or replace it and return it free of charge.

However, we will not be responsible for damage from misuse or normal wear and tear incurred during use.

Warranty is void if a non-recommended or poor-quality battery is used.

Under no circumstances will Scientific Glass Technology Singapore Pte Ltd be responsible for damages or loss beyond the value of the device itself, including, but not limited to, the loss of equipment, consumables, or lost time.

Manufacturer contact information:

Scientific Glass Technology Singapore Pte Ltd
83 Science Park Drive
#01-01 The Curie
118258 Singapore
www.sgt-nl.com
support@sgtnl.com

Compliance



Legal Information

Patent pending: PCT/NL2012/050477

Ordering Information

Electronic Indicator Kits for Super Clean® Gas Filters

22645 Electronic Indicator Kit for Super Clean® Gas Filters

Spare Parts

22648 Replacement Battery

Note: Due to international shipping restrictions, this part can only be shipped via ground in the contiguous U.S.

For customers in other markets, the replacement battery will need to be purchased locally, or the device must be powered using the supplied USB cable.

**Questions about this or any other Restek® product?
Contact us or your local Restek® representative
(www.restek.com/contact-us).**

Restek® patents and trademarks are the property of Restek Corporation. (See www.restek.com/Patents-Trademarks for full list.) Other trademarks in Restek® literature or on its website are the property of their respective owners. Restek® registered trademarks are registered in the U.S. and may also be registered in other countries.

© 2016 Restek Corporation.
All rights reserved.

www.restek.com

#204-08-022 Rev. date: 03/16

RESTEK
Pure Chromatography

RESTEK

Electronic Indicator for Super Clean® Gas Filters

User Guide



For Model:

22645

www.restek.com

Overview

The Electronic Maintenance Indicator is a monitoring device that sounds an alarm when planned maintenance or replacement for a consumable is due.

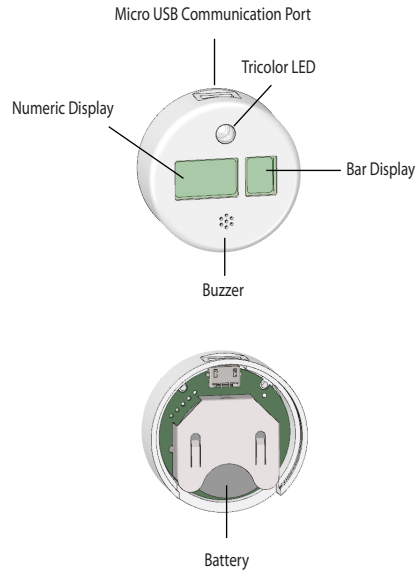

For Super Clean® gas filters, the following models can be used.

22645



Electronic Maintenance Indicator with clip for Super Clean® cartridge filter

Specifications

Category	Description
Power requirements	3 V CR2450 non-rechargeable lithium coin cell battery
Operating temperature range	0 ~ +48 (C)
Storage temperature	-10 ~ +55 (C)
Operating humidity	10-80 % relative humidity, noncondensing
Storage humidity	10-90 % relative humidity, noncondensing
Recommended configured time range	1 month ~ 3 years
Battery lifetime	> 1 year
Communication	Micro-B USB Connector
Warranty	2-year factory warranty from the date of purchase
Certifications	CE, FCC
Compliance	RoHS, WEEE

Safety Information

- There are no serviceable parts in this unit. Opening the device—other than to change the battery—or tampering with the internal parts, will void the factory warranty.
- Not intended for outdoor use or wet locations.
- Always obtain prior authorization from your supervisor before installing or using this device in controlled, hazardous, or restricted environments.

Battery Storage and Handling

- Do not swallow the battery. Keep this device out of reach of children. Lithium coin cells can cause serious injury or death if swallowed.
- Do not try to open the battery, and do not expose the battery to open flame. Exposure to the ingredients contained within, or their combustion products, could be harmful.
- Do not short-circuit battery. Short-circuiting the battery may cause leakage and high heat, which can cause burns.
- Only remove the battery protection tab when you start using the device. When you are not using the device, remove the battery and store it in a dry, secure place away from other batteries or heat sources and out of reach of children.

1. Quick Start

1.1 Enabling the Device

The battery is preinstalled into the device and disabled by a battery-protection tab. To initialize (start) the device with its default settings, pull the battery protection tab out.

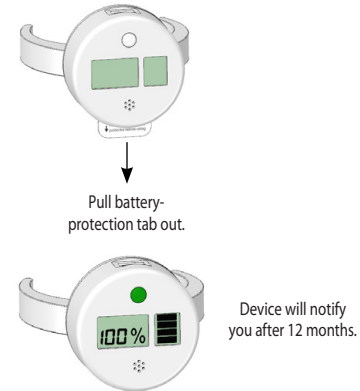

1.2 Default Device Settings

The default configured maintenance interval of the device is factory set to 12 months. However, it is possible that your service agent or instrument/consumable manufacturer have pre-configured a different recommended lifetime for your consumable.

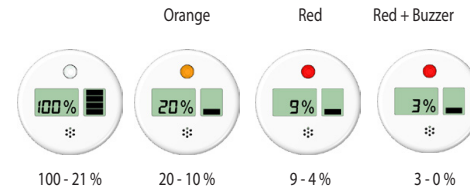

1.3 Resetting Device / Manual Configuration

For manual configuration, download and install the latest version of the configuration software utility at www.sgt-nl.com and connect the device to your computer with a Micro USB cable.

www.sgt-nl.com



2. Installing the Device

Always ensure that the consumable or surface onto which you are mounting the device will never exceed the operating temperature limits as described in the specifications.

2.1 For Super Clean® Gas Filters without Universal Screw Ring

Clip the device (22645) onto the plastic outer casing of the filter as shown in the illustration below.

